

MAP  
of a proposed change in the east line of  
**BENEFIT STREET**

Surveyed & drawn by order of  
The Board of Aldermen.  
by W<sup>m</sup> S Haines  
Sept 15<sup>th</sup> 1857

Robert H. Ives

John Carter Brown

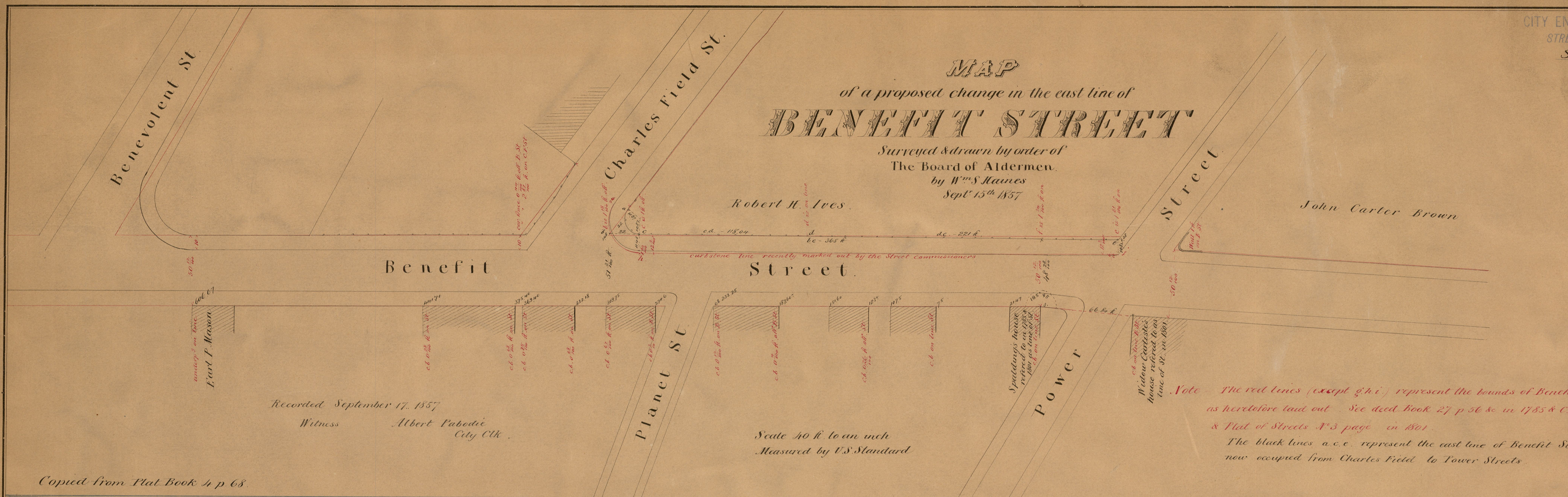

Recorded September 17, 1857  
Witness Albert Fabbodi  
City Clk.

Scale 40 ft to an inch  
Measured by U.S Standard

Note - The red lines (except g.h.) represent the bounds of Benefit Street as heretofore laid out. See deed Book 27 p 56 & in 1785 & C.R.B. 8 p 6 & Plat of Streets A 3 page in 1801.  
The black lines a.c.e. represent the east line of Benefit Street as now occupied from Charles Field to Tower Streets.

Copied from Plat Book 4 p 68.

Reference to the Records

W <sup>m</sup> M. Bailey	{ B 21 P 564 (1786)	---	B 45 P 344 (1825)
Geo W Heely & Wife	{ " 22 " 40 " " " }	---	66 " 285 (1835)
John S Parkis	{ " 60 " 411 (1792)	---	60 " 63 & 142 (1831)
Knight Street	{ " 47 " 282 (1824)	---	66 " 303 (1835) B 63 T 167 (1836)
Nancy Angell	{ " 60 " 411 (1792)	---	68 " 206 (1836) - 99 " 22 (1845)
Horatio Angell	" " " " " " " "	---	B 118 P 231 (1850)
Pardon Angell & John Angell's heirs	" " " " " " " "	---	" 118 " 230 (1850)
Tillinghast Sheldon	" 43 " 188 (1819)	---	" " " " " " " "
W <sup>m</sup> E Richmond	B 40 P 69 (1816)	---	B 45 P 12 (1825)

Note - The Lines Figures &c in "Red" represent the Bounds of Knight St, according to the best evidence I can find, having reference especially to the Deeds & Plats on Record as indicated in "Blue" ink, and to the Stone bound set Horatio Angell for the corner of High & Knight St in conformity with the old barn & fence which stood there, at the time, & having refer also to the Trees & Stumps of Trees, now standing near the West end of Knight St between Carpenter & High Sts.  
The figures &c in "Black" represent the bounds of Knight St as now occupied.

W<sup>m</sup> S Haines  
CITY ENGINEER'S  
STREET LINE D  
Oct. 1857  
0416

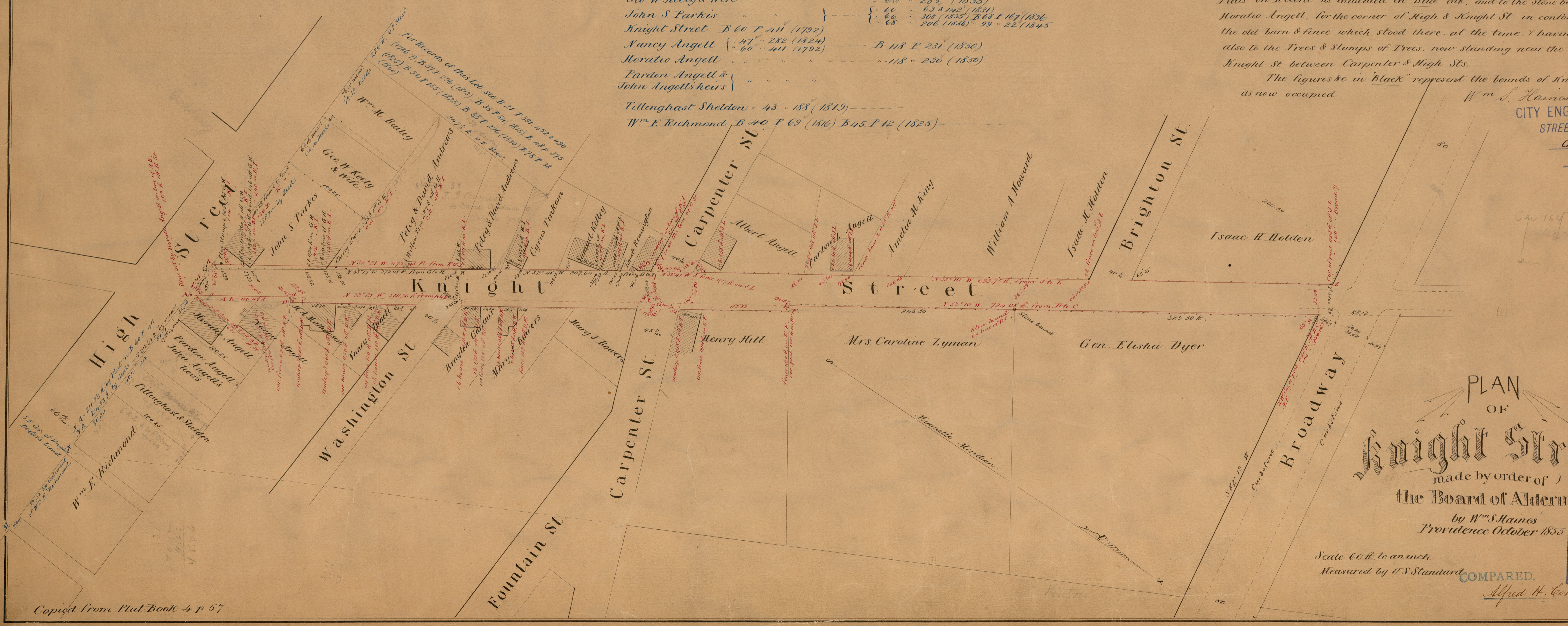

PLAN  
OF  
**Knight Street**  
made by order of )  
the Board of Aldermen  
by W<sup>m</sup> S Haines  
Providence October 1855

Scale 60 ft to an inch  
Measured by U.S Standard

OFFICE DRAW SHEET  
COMPARED  
Alfred H. Combe

Copied from Plat Book 4 p 57.